

# MK3 RAIL SQUARE ULTRA REPEAT STOP SET UP INSTRUCTIONS

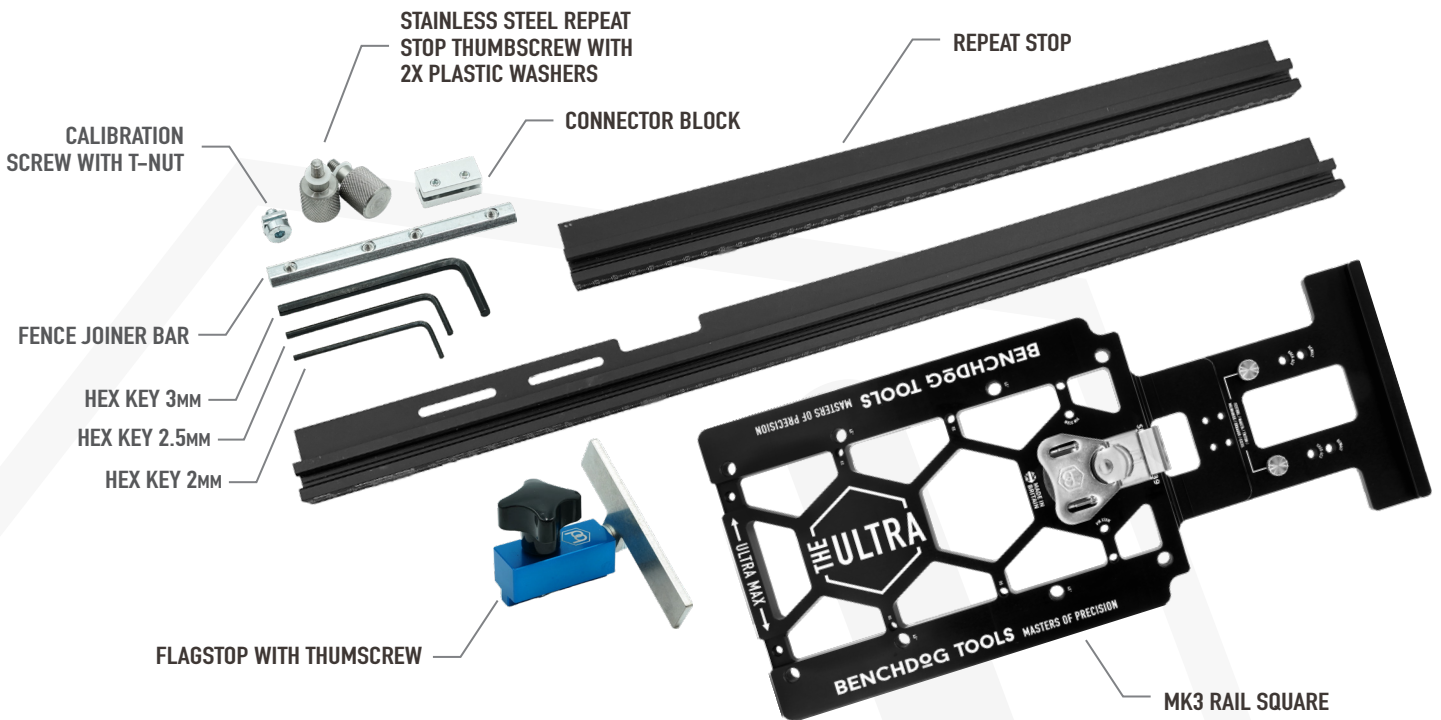

TAKE THE MK3 REPEAT STOP AND LOCATE THE LONG SLOTS WITH THE FLAT SIDE OF THE EXTRUSION FACING DOWN.



LOCATE THE RS (REPEAT STOP) HOLES



LINE UP THE REPEAT STOP SLOTS TO THE RS HOLES ON THE RAIL SQUARE



TAKE THE SUPPLIED THUMBSCREWS WITH THE PLASTIC WASHERS.

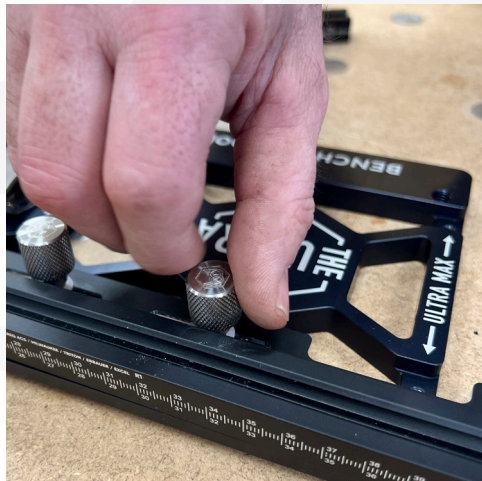

SCREW DOWN THE REPEAT STOP BUT DON'T FULLY TIGHTEN.

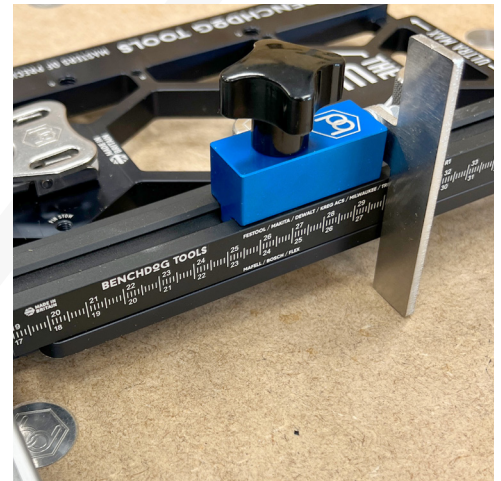

SLIDE ON YOUR FLAGSTOP AND TIGHTEN DOWN THE THUMBSREW AT YOUR CHOSEN LENGTH (WE HAVE SET IT AT 30MM)

# MK3 RAIL SQUARE ULTRA REPEAT STOP SET UP INSTRUCTIONS



USING A RULER OR TAPE MEASURE, SLIDE IT UNDER YOUR TRACK AND BUTT IT UP TO THE FLAGSTOP.



SLIDE THE REPEAT STOP TOWARDS THE TRACK AND CHECK THAT THE MEASUREMENT IS READING THE SAME MEASUREMENT ON THE RULER / TAPE MEASURE.

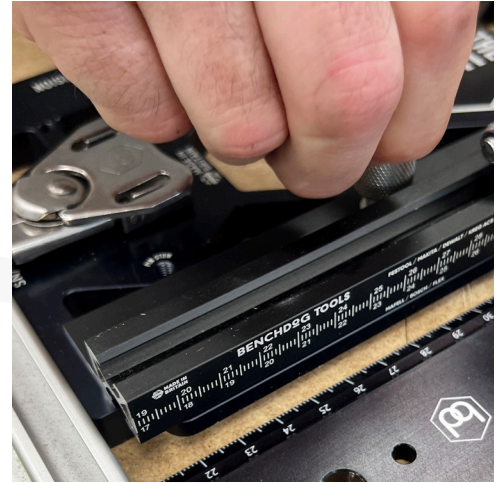

TIGHTEN UP THE THUMBSCREWS ONCE THE MEASUREMENT HAS BEEN SET.



UNSCREW THE T-NUT SO IT IS TO THE TIP OF THE SCREW.



THEN SLIDE THE CALIBRATION SCREW WITH THE ATTACHED T-NUT INTO THE REPEAT STOP ON THE UNDERSIDE.

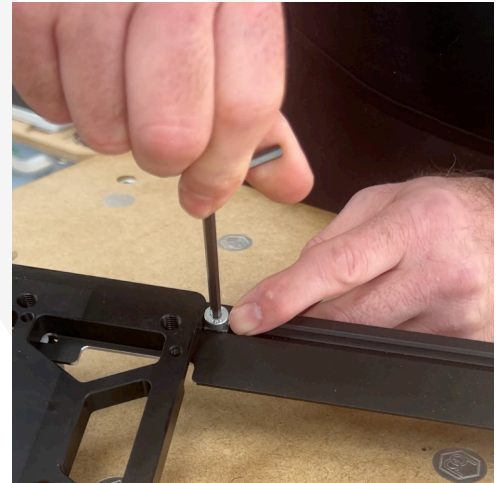

SLIDE THIS UP TO THE RAIL SQUARE AND USING THE 3MM HEX KEY TIGHTEN THIS UP AND THAT IS NOW CALIBRATED.

## REPEAT STOP EXTENTION

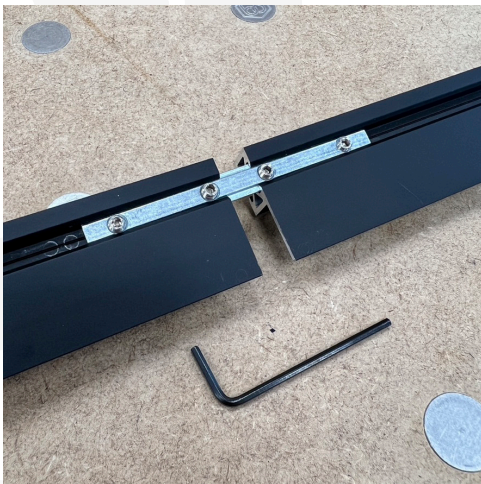
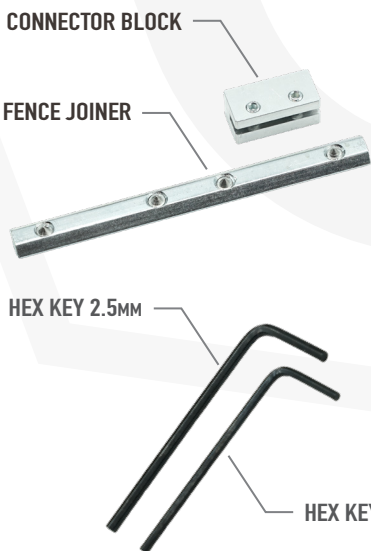

FOR EXTENDING YOUR REPEAT STOP YOU WILL NEED THE FENCE JOINER TO JOIN THE TWO HALVES TOGETHER.

START BY HAVING THE FLAT PART OF THE REPEAT STOP FACING YOU. SLOT THE FENCE JOINER IN ONE SIDE OF THE REPEAT STOP FOLLOWED BY THE OTHER SIDE. PUSH THE TWO HALVES TOGETHER UNTIL THEY MEET. THEN SECURE BY TIGHTENING UP THE GRUBSCREWS WITH A 2.5MM HEX KEY.



TAKING THE CONNECTOR BLOCK, YOU CAN SLIDE THIS ONTO THE EDGE, MAKING SURE ITS RIGHT IN THE MIDDLE OF THE JOIN. USING A 2MM HEX KEY YOU CAN TIGHTEN UP THE GRUBSCREWS AND THIS IS NOW SECURELY FIXED INTO PLACE.